

## **UPPER POPPLETON**

### **Conservation Area No. 16 (18.2 ha)**

#### **Introduction**

Upper Poppleton Conservation Area was designated in 1993 originally. It embraced the village green and its approaches along Hodgson Lane and Main Street. On 16 December 2004 the Conservation Area was extended to include the following: Beechway Close and the adjoining part of Main Street; part of Long Ridge Lane; land and buildings south of Black Dike Lane; the remainder of Beech Grove and adjoining paddocks and gardens; paddocks to the rear of Model Farm, The Green; and a small extension along School Lane. Also at the same time Nos 1-5 (consecutive) Grove Gardens were deleted from the Conservation Area.

#### **History**

The Old English name “popel” probably means “pebble” and “tun” implies a non-forested landscape or hamlet/farm. Thus Poppleton may have originated as “a farmstead on pebbly soil” (a reference to local glacial sands and gravels) or “by a pebbly bank” (the higher land on the edge of the river). “Upper” implies that the settlement is further from the river. The earliest reference to Upper Poppleton is in Domesday Book (1086), when the greater part of the manor was held by the Archbishop of York but Osbern de Arches was recorded as a subsidiary land holder. The original manor house was probably sited close to the present house of that name. All Saints Church was originally a “minster” church, thought to be of Norman beginnings, but was rebuilt in 1891. The railway came to Poppleton in 1848, later facilitating extensive 20C development as a commuter settlement, the present population being about 1900 people.

#### **Important Buildings**

Several of the houses and farmhouses around the village green are listed buildings including Model Farmhouse and Barn, and Manor Farmhouse, together with their gates and railings. The listed buildings all date from the 18C. Although not listed, All Saint’s Church is also important to the character of the green.

#### **Character**

The triangular village green overlooked by houses on all sides creates Upper Poppleton’s particular character. Roads approach each corner of the green and along two of these - Main Street and Hodgson Lane - subsidiary greens extend. Overall there is an interesting spatial quality, to which the several mature trees contribute. The pump and maypole epitomise the role of the green as the focal point of village life.

Attractive groups of 18C and 19C two-storey houses front onto the green, interspersed by some more recent development. The houses tend to be detached or in pairs. They are sited close together, often having small front gardens defined by boundary walls with several examples of fine wrought iron railings and gates. All Saints’ Church is set back from the frontage and has mature pine trees in the churchyard.

On the south-east side of the green and along part of the north-west side, the medieval pattern of long, narrow plots extending to the open fields remains, being important to the setting of the village. However the 20C housing development, which in effect links Nether Poppleton and Upper Poppleton, extends up to the rear of the frontage buildings on the north-east side of the village core.

Brick is the predominant building material, and there are examples of different bonding such as English Garden Wall and Flemish Bond. Some properties are rendered brick. Roofing is generally of pantile or Welsh slate.

The main elements of the character and appearance of the area are:-

1. The essentially rural village quality of the green, with its individual triangular shape and the subsidiary greens leading from it.
2. The attractive groups of vernacular buildings, sufficient to create a cohesive overall character, and a valuable focal point in an area that has undergone extensive suburban expansion.
3. The rural setting that remains to the south-east and north-west of the village core.

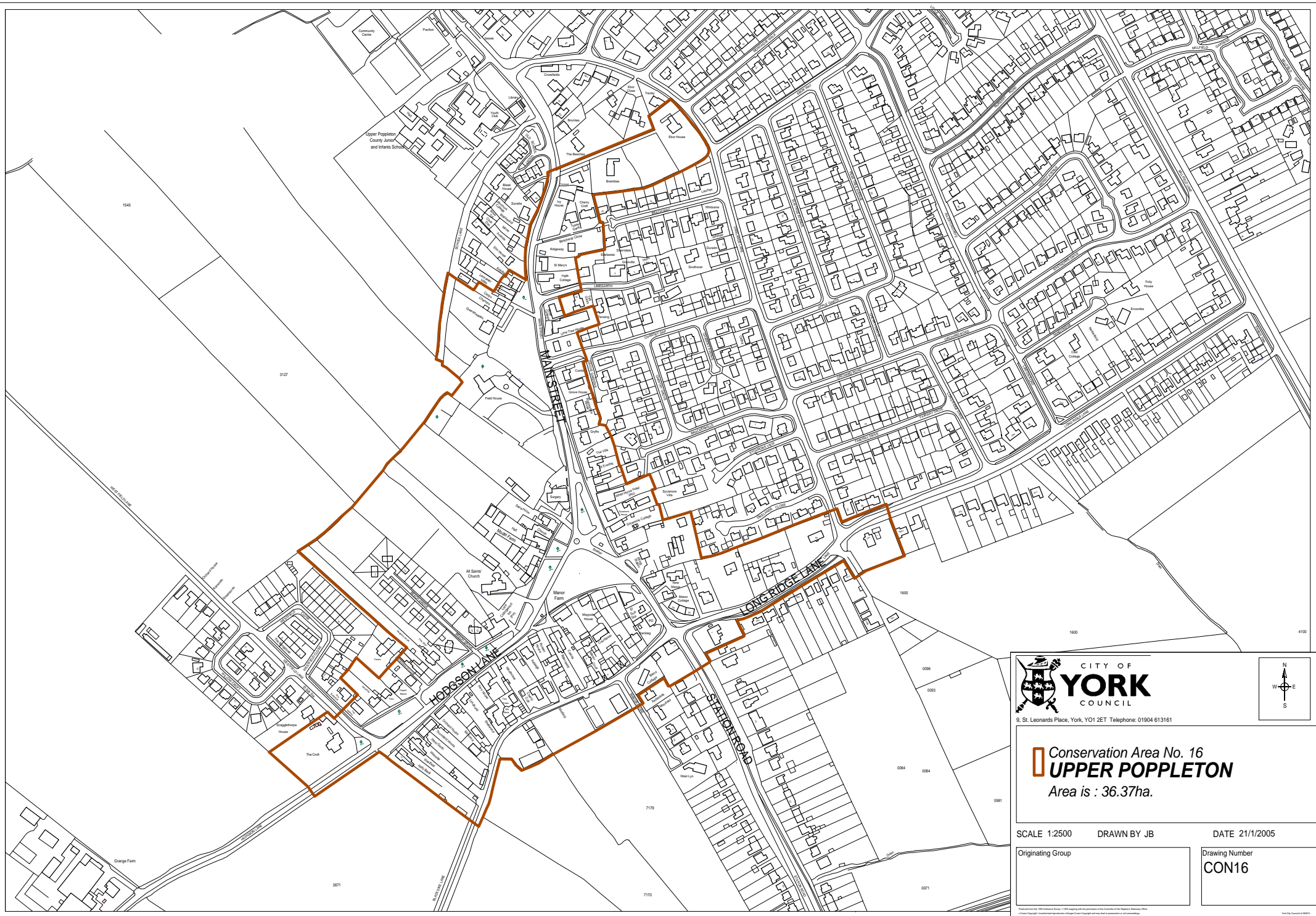

**CITY OF YORK COUNCIL**  
 9, St. Leonards Place, York, YO1 2ET Telephone: 01904 613161



**Conservation Area No. 16**  
**UPPER POPPLETON**  
 Area is : 36.37ha.

SCALE 1:2500    DRAWN BY JB    DATE 21/1/2005

Originating Group	Drawing Number <b>CON16</b>
-------------------	--------------------------------

Prepared by: 1997/2005 Planning and the provision of 2002 Council of the Mayor, Secretary, Clerk  
 Crown Copyright. Information on the map is the property of the Crown and may not be reproduced without permission.